

Sample Permanent Compost Toilet Design

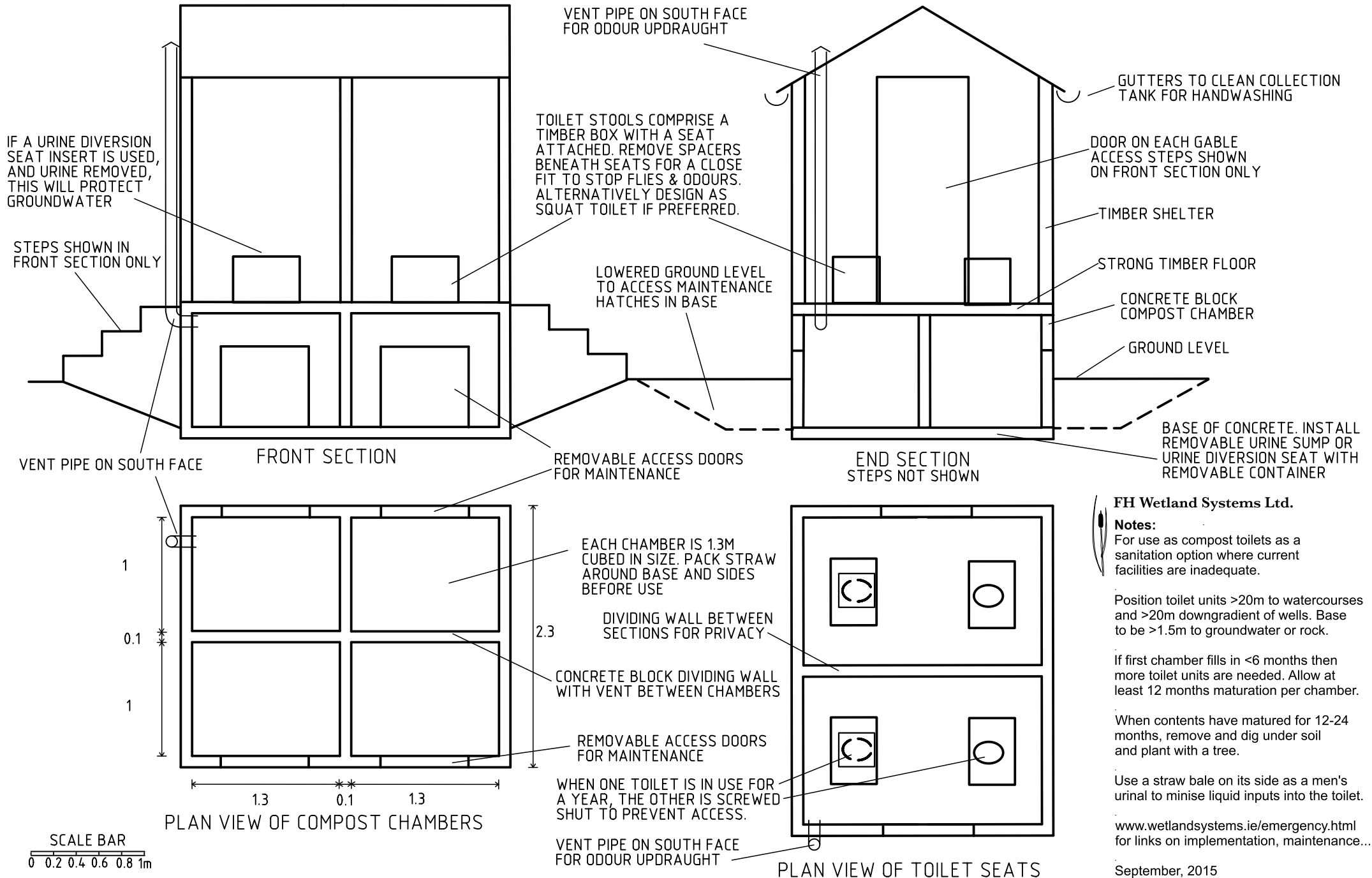

FH Wetland Systems Ltd.

Notes:
For use as compost toilets as a sanitation option where current facilities are inadequate.

Position toilet units >20m to watercourses and >20m downgradient of wells. Base to be >1.5m to groundwater or rock.

If first chamber fills in <6 months then more toilet units are needed. Allow at least 12 months maturation per chamber.

When contents have matured for 12-24 months, remove and dig under soil and plant with a tree.

Use a straw bale on its side as a men's urinal to minimise liquid inputs into the toilet.

www.wetlandsystems.ie/emergency.html for links on implementation, maintenance...

September, 2015